

WERSJA GWINTOWANA

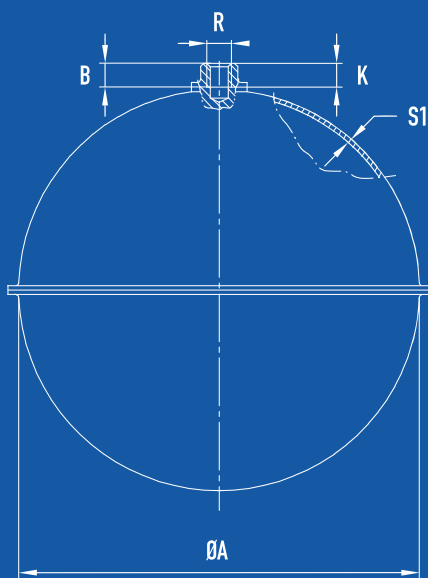

WERSJA NIEGWINTOWANA

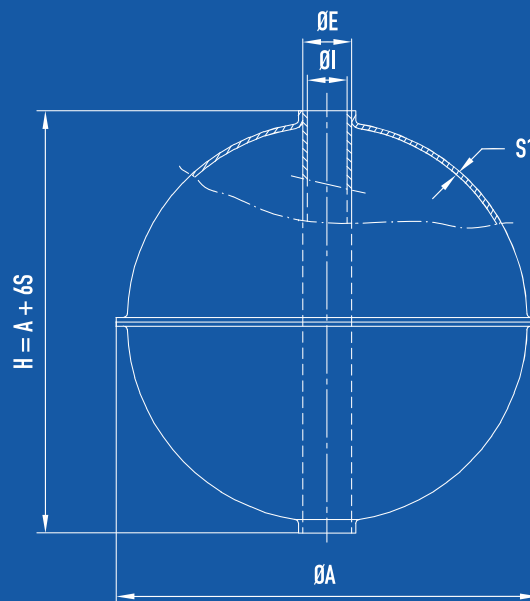

WYMIARY [MM]								WAGA [KG]	MAX WYPORNOŚĆ W WODZIE (20°) ¹		MAX CIŚNIENIE PRACY [BAR]		
PŁYWAK			PRZYŁĄCZE						N	kG	20°C	100°C	200°C
ØA	ØB	S1	R	K	B	ØI	ØE						
50	52.0	0.5 ^{-0.05}	M6	9	5.5	-	-	0.033	0.333	0.034	32.50	28.40	23.30
			-	-	-	13.5	14.5	0.037	0.216	0.022	38.30	33.60	27.60
60	64.3	0.6 ^{-0.1}	M6	4	7	-	-	0.053	0.630	0.064	30.00	26.10	21.00
			-	-	-	13	15	0.066	0.424	0.043	34.00	29.90	24.00
90	96.0	0.6 ^{-0.1}	M6	4	7	-	-	0.118	2.491	0.254	22.50	19.80	16.30
			-	-	-	13	15	0.141	2.138	0.218	25.00	22.00	18.00
110	117.0	0.8 ^{-0.1}	M6	4	7	-	-	0.235	4.502	0.459	24.00	21.10	17.40
			-	-	-	13	15	0.266	4.032	0.411	25.50	22.40	18.20
120	128.0	0.8 ^{-0.1}	M6	4	7	-	-	0.269	6.494	0.662	21.00	18.40	15.10
			-	-	-	13	15	0.334	5.690	0.580	22.00	19.30	15.80
130	135.0	0.8 ^{-0.1}	M6	4	7	-	-	0.315	8.191	0.835	19.00	16.60	13.60
			-	-	-	13	15	0.354	7.641	0.779	19.80	17.30	14.20
150	159.0	0.6 ^{-0.1}	M8	4	8	-	-	0.300	13.940	1.422	9.50	8.40	6.90
			-	-	-	13	15	0.345	13.020	1.328	10.00	8.80	7.20
160	169.0	0.8 ^{-0.1}	M8	4	8	-	-	0.491	16.661	1.698	12.00	10.60	8.70
			-	-	-	13	15	0.539	15.970	1.628	12.40	10.90	8.90
200	211.0	0.8 ^{-0.1}	M12	10	16	-	-	0.747	33.080	3.372	10.00	8.80	7.20
			-	-	-	13	15	0.792	32.420	3.305	10.30	9.00	8.90
250	263.0	1.2 ^{-0.15}	M12	10	16	-	-	1.585	59.890	6.100	13.30	11.60	9.50
			-	-	-	13	15	1.648	58.940	6.010	13.50	11.80	9.70
300	315.0	1.0 ^{-0.15}	M12	10	16	-	-	2.781	115.100	11.740	9.50	8.30	6.70
			3/8" G	12	16	-	-	2.781	115.100	11.740	9.65	8.30	6.70
			-	-	-	13	15	2.881	113.790	11.600	9.65	8.50	6.90
400	415.0	1.0 ^{-0.1}	M12	10	16	-	-	4.513	291.020	29.660	7.00	6.10	4.90
			3/8" G	12	16	-	-	4.513	291.020	29.660	7.00	6.10	4.90
			-	-	-	13	15	4.627	289.390	29.490	7.10	6.20	5.00

¹ 1N = 0,10197 KG

*Dane orientacyjne - producent zastrzega sobie prawo do wprowadzania zmian w konfiguracji technicznej.